

FORM B – BUILDING

Assessor's Number USGS Quad Area(s) Form Number

MASSACHUSETTS HISTORICAL COMMISSION
MASSACHUSETTS ARCHIVES BUILDING
220 MORRISSEY BOULEVARD
BOSTON, MASSACHUSETTS 02125

24D-181 Easthampton NTH.336

Town: Northampton

Place: (*neighborhood or village*)

Photograph



Address: 22 Aldrich Street

Historic Name: James and Ellen Powers House

Uses: Present: single-family residence

Original: single-family residence

Date of Construction: 1894-1895

Source: Northampton street directories

Style/Form: Queen Anne

Architect/Builder: James Powers, builder

Exterior Material:

Foundation: brick

Wall/Trim: clapboard

Roof: slate

Outbuildings/Secondary Structures:

Major Alterations (*with dates*):

Windows replaced ca. 2000

Condition: good

Moved: no | x | yes | | **Date** _____

Acreage: 0.104 acres

Setting: This house is on a relatively narrow street with closely placed buildings, all shaded by mature trees.

Topographic or Assessor's Map

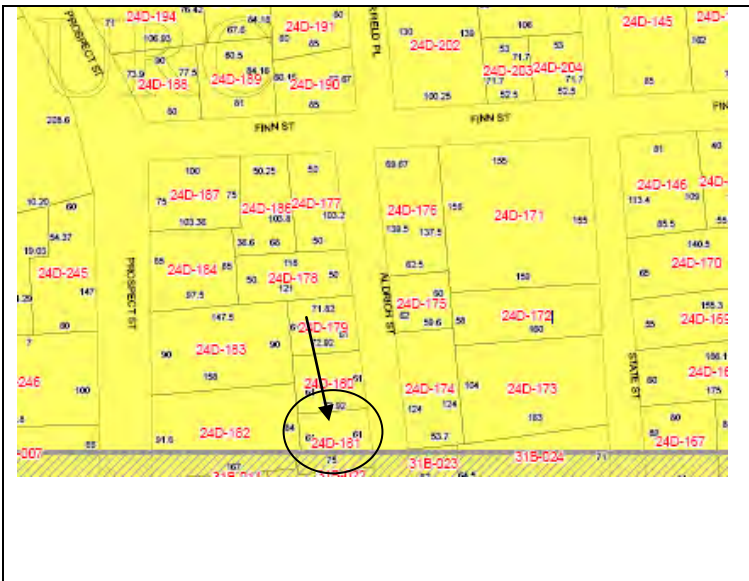

Recorded by: Bonnie Parsons

Organization: PVPC

Date (*month / year*): March, 2010

INVENTORY FORM B CONTINUATION SHEET

[NORTHAMPTON]

[22 ALDRICH STREET]

MASSACHUSETTS HISTORICAL COMMISSION

220 MORRISSEY BOULEVARD, BOSTON, MASSACHUSETTS 02125

Area(s) Form No.

NTH.331

Recommended for listing in the National Register of Historic Places.

If checked, you must attach a completed National Register Criteria Statement form.

Use as much space as necessary to complete the following entries, allowing text to flow onto additional continuation sheets.

ARCHITECTURAL DESCRIPTION:

Describe architectural features. Evaluate the characteristics of this building in terms of other buildings within the community.

This is a relatively unornamented Queen Anne style house and is nearly identical to its neighbor at 26 Aldrich Street although the latter is in masonry. It is two-and-a-half stories in height under a pyramidal hipped roof with transverse gable bays on both the principal east façade and the south elevation for a complex plan. The clapboard-sided house has a stacked porch in the angle created by the east bay. The porch on the first floor is two bays wide and has a stacked section at the second floor level that is one bay wide. The porch rests on posts with capitals below thin impost blocks and has a simple square baluster railing. There is a two-and-a-half story ell on the rear with a one-story side porch under a shed roof that is supported on posts. Eaves of the roof make returns and beneath the returns in the transverse gable bay are scrolled brackets.

HISTORICAL NARRATIVE

Discuss the history of the building. Explain its associations with local (or state) history. Include uses of the building, and the role(s) the owners/occupants played within the community.

From the 1980 form, "In 1892 Avon C. Matthews, a prominent Northampton building contractor filed a subdivision plan for Aldrich Street. Two years later he sold "lot no. 3" to James Powers, a mason and builder. Mr. Powers probably built the house himself. He is listed as living here in the 1895-1896 directory. " By 1910 Oliver and Elmira Vanasse occupied the house with their six children, five of whom worked in a hosiery mill as joiners and knitters. Oliver and Elmira and all but the last of their children were French Canadian immigrants, and Oliver worked as a silk mill dyer in Florence. By 1920 Elmira had died and Oliver lived here with two of his adult daughters Rose and Olympe. Rose had stopped working and Olympe had become a hair dresser.

BIBLIOGRAPHY and/or REFERENCES

Walker, George H. and Company. Atlas of Northampton City, Massachusetts, Boston, 1884.

Miller, D. L. Atlas of the City of Northampton and Town of Easthampton, Hampshire County, Massachusetts, Philadelphia, 1895.

Registry of Deeds: Book 465, Page 144; Book 453, Page 49.

Northampton Directory, 1895-1896.

INVENTORY FORM B CONTINUATION SHEET

[NORTHAMPTON]

[22 ALDRICH STREET]

MASSACHUSETTS HISTORICAL COMMISSION
220 MORRISSEY BOULEVARD, BOSTON, MASSACHUSETTS 02125

Area(s) Form No.

	NTH.331
--	---------

National Register of Historic Places Criteria Statement Form

Check all that apply:

- Individually eligible Eligible only in an historic district
- Contributing to a potential historic district Potential historic district

Criteria: A B C D

Criteria Considerations: A B C D E F G

Statement of Significance by Bonnie Parsons
The criteria that are checked in the above sections must be justified here.

The Powers House contributes to a potential historic district on Aldrich and Myrtle Streets, an area that was laid out for residential development between 1870 and 1900 when Northampton’s population was expanding to fill the growing manufacturing, commercial, and institutional enterprises that drew people to the city during those decades. It is significant to Northampton as it incorporates the work of speculative Northampton builders such as Avon Matthews and James Powers whose well-constructed houses are representative of the high level of construction that took place in Northampton to serve the developing middle class.

The potential historic district is significant architecturally for the mix of late Gothic Revival, Italianate, and Queen Anne style houses that were set in alignment on the newly laid out urban streets. They are significant for the manner in which they were builder-designed in patterns similar in plan and elevation but differentiated in materials and architectural details to create neighborhoods that are picturesque in the fashion prescribed by the architectural trends of the fourth quarter of the 19th century.