

FORM B – BUILDING

Assessor's Number USGS Quad Area(s) Form Number

24C-144	Easthampton		NTH.309
---------	-------------	--	---------

MASSACHUSETTS HISTORICAL COMMISSION
 MASSACHUSETTS ARCHIVES BUILDING
 220 MORRISSEY BOULEVARD
 BOSTON, MASSACHUSETTS 02125

Town: Northampton

Place: (*neighborhood or village*)

Photograph



Address: 13 Arlington Street

Historic Name: John and Emily Huxley House

Uses: Present: two-family residence

Original: single-family residence

Date of Construction: 1871-1873

Source: Registry of Deeds and atlas of 1873

Style/Form: no style

Architect/Builder: John Huxley, attributed

Exterior Material:

Foundation: brick

Wall/Trim: vinyl

Roof: asphalt shingles

Topographic or Assessor's Map

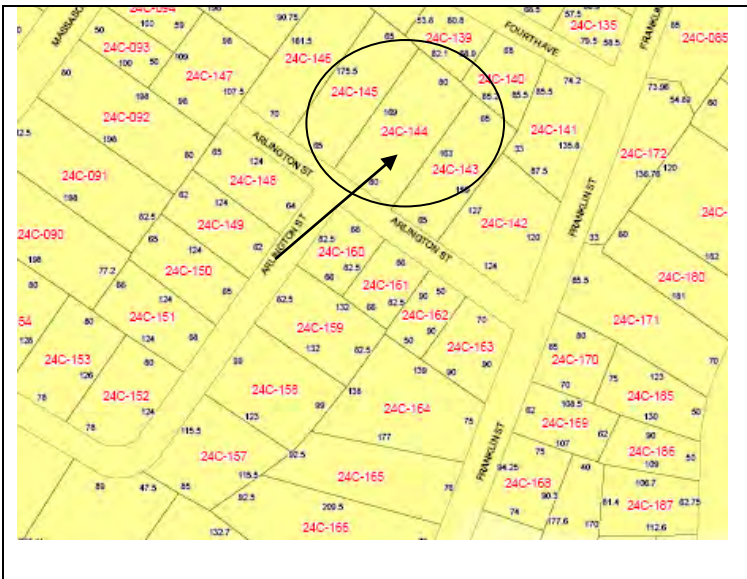

Outbuildings/Secondary Structures:

Major Alterations (*with dates*):

Roof raised, porch added, house sided and windows replaced as part of conversion to two-family house.

Condition: good

Moved: no | x | yes | | **Date** _____

Acreage: 0.302 acres

Setting: This house rests on a slightly raised lot, faces south and is shaded by a large oak tree.

Recorded by: Bonnie Parsons

Organization: PVPC

Date (month / year): March, 2010

INVENTORY FORM B CONTINUATION SHEET

[NORTHAMPTON]

[13 ARLINGTON STREET]

MASSACHUSETTS HISTORICAL COMMISSION

220 MORRISSEY BOULEVARD, BOSTON, MASSACHUSETTS 02125

Area(s) Form No.

NTH.309

___ Recommended for listing in the National Register of Historic Places.

If checked, you must attach a completed National Register Criteria Statement form.

Use as much space as necessary to complete the following entries, allowing text to flow onto additional continuation sheets.

ARCHITECTURAL DESCRIPTION:

Describe architectural features. Evaluate the characteristics of this building in terms of other buildings within the community.

This house was altered in its conversion to a two-family so that its original appearance is no longer discernable. It has lost its character and has no remaining stylistic features of significance. It is a vinyl-sided, three-story house with a front-gable roof. A two-story porch has been added to its façade. There is a two-story wing on the east and perhaps the only remaining historical feature on the exterior, though an addition after construction of the house, is a Queen Anne style stained glass stair window on the east elevation of the main block.

HISTORICAL NARRATIVE

Discuss the history of the building. Explain its associations with local (or state) history. Include uses of the building, and the role(s) the owners/occupants played within the community.

According to a Form B prepared in 1980, "A subdivision plan for Arlington Street was filed by W. T. Clement in 1871. This new street was to connect Franklin and Massasoit Streets through an S-curve. That same year John Huxley bought lots number 10 and 11 for \$600. Mr. Huxley was a carpenter and probably built this house himself. It first appears on the 1873 atlas and served as Mr. Huxley's homestead."

In 1880 John and Emily Huxley were living in Northampton with their children Frank and Alice and Emily's father Elijah Montague. At that point, John was a junior carpenter, but by 1893 John had become a full-fledged carpenter and the family was in this house on Arlington Street. In 1895 John began listing himself as a builder/carpenter suggesting that he was investing in properties or building houses for others and Alice was teaching at the Center Grammar School, while Frank had moved to 19 Arlington Street but worked with his father as a carpenter/builder.

BIBLIOGRAPHY and/or REFERENCES

Beers, F. W. County Atlas of Hampshire Massachusetts, New York, 1873.

Hales, John G. Plan of the Town or Northampton in the County of Hampshire, 1831.

Miller, D. L. Atlas of the City of Northampton and Town of Easthampton, Hampshire County, Massachusetts, Philadelphia, 1895.

Walker, George H. and Company. Atlas of Northampton City, Massachusetts, Boston, 1884.

Walling, Henry F. Map of Hampshire County, Massachusetts, New York, 1860.

Northampton Directory. 1873-74 and 1895-96.

Registry of Deeds. Book 280, Page 283; Book 284, Page 271.