

FORM B – BUILDING

MASSACHUSETTS HISTORICAL COMMISSION
MASSACHUSETTS ARCHIVES BUILDING
220 MORRISSEY BOULEVARD
BOSTON, MASSACHUSETTS 02125

Assessor's Number USGS Quad Area(s) Form Number

31B-172 Easthampton NTH.654

Town: Northampton

Place: (*neighborhood or village*)

Photograph



Address: 32 Barrett Place

Historic Name: Benjamin Barrett Hinckley House

Uses: Present: single-family residence

Original: single-family residence

Date of Construction: 1905-1915

Source: Directory and atlas

Style/Form: Colonial Revival

Architect/Builder:

Exterior Material:

Foundation: brick

Wall/Trim: clapboards

Roof: asphalt shingles

Outbuildings/Secondary Structures:
garage

Major Alterations (*with dates*):

Condition: good

Moved: no | x | yes | | **Date** _____

Acreage: 0.237 acres

Setting: North-facing, this house is at the end of a short, dead-end residential street that is shaded by mature trees.

Topographic or Assessor's Map

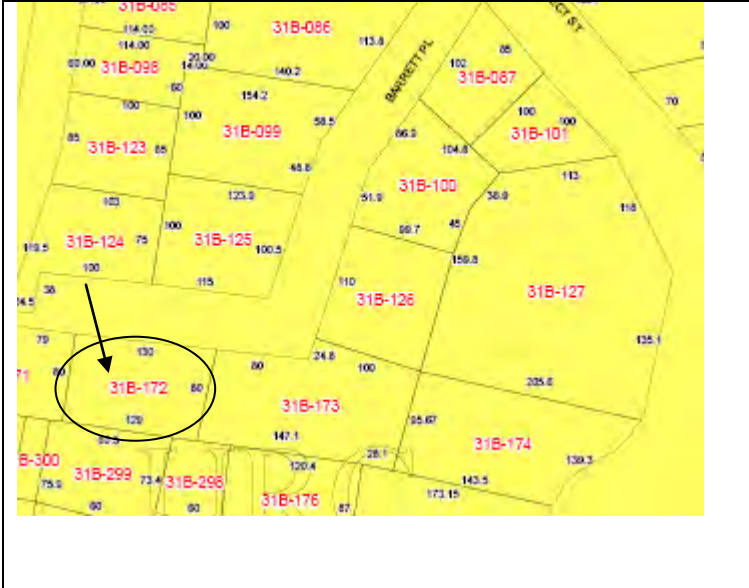

Recorded by: Bonnie Parsons

Organization: PVPC

Date (*month / year*): March, 2010

INVENTORY FORM B CONTINUATION SHEET

[NORTHAMPTON]

[32 BARRETT PLACE]

MASSACHUSETTS HISTORICAL COMMISSION
220 MORRISSEY BOULEVARD, BOSTON, MASSACHUSETTS 02125

Area(s) Form No.

NTH.654

Recommended for listing in the National Register of Historic Places.
If checked, you must attach a completed National Register Criteria Statement form.

Use as much space as necessary to complete the following entries, allowing text to flow onto additional continuation sheets.

ARCHITECTURAL DESCRIPTION:

Describe architectural features. Evaluate the characteristics of this building in terms of other buildings within the community.

Probably the grandest of the houses on Barrett Place, the Benjamin Barrett Hinckley House is a 20th century Colonial Revival interpretation of his parents' Georgian house, which is close by and known as The Manse. It is a two-and-a-half story house under a side-gambrel roof with two interior chimneys. It is five bays wide and a generous three bays deep, and there are three shed roof dormers arranged on the north side of its gambrel roof. Like its neighbor at 7 Barrett Place the house has porches on both its east and west elevations supported on Doric columns, although the west porch in this house is partially enclosed. The center entry has a barrel vaulted portico on paired Doric columns with respondent pilasters framing the doorway. Above the door is a gold-painted carved shell, repeating the motif and use of a barrel vault of 4 Barrett Place. Windows have 9/1 sash and crown molding lintels. Sidelights flanking the entry have curved, geometric muntins in a pattern that was common during the late Federal Period.

HISTORICAL NARRATIVE

Discuss the history of the building. Explain its associations with local (or state) history. Include uses of the building, and the role(s) the owners/occupants played within the community.

From the 1980 Form B: "Barrett Place was laid out in 1910 through a portion of the H. R. Hinckley Estate on Prospect Street (known as 'The Manse'). Benjamin Barrett Hinckley was a son of H. R. Hinckley and had this house built by 1915 when it appears on the atlas. Benjamin was clerk of the Northampton Cutlery Company and later became manager of the International Silver Company in Florence."

BIBLIOGRAPHY and/or REFERENCES

- Beers, F. W. County Atlas of Hampshire Massachusetts, New York, 1873.
Hales, John G. Plan of the Town or Northampton in the County of Hampshire, 1831.
Miller, D. L. Atlas of the City of Northampton and Town of Easthampton, Hampshire County, Massachusetts, Philadelphia, 1895.
Walker, George H. and Company. Atlas of Northampton City, Massachusetts, Boston, 1884.
Walling, Henry F. Map of Hampshire County, Massachusetts, New York, 1860.

INVENTORY FORM B CONTINUATION SHEET

[NORTHAMPTON]

[32 BARRETT PLACE]

MASSACHUSETTS HISTORICAL COMMISSION
220 MORRISSEY BOULEVARD, BOSTON, MASSACHUSETTS 02125

Area(s) Form No.

	NTH.654
--	---------

National Register of Historic Places Criteria Statement Form

Check all that apply:

- Individually eligible Eligible only in an historic district
- Contributing to a potential historic district Potential historic district

Criteria: A B C D

Criteria Considerations: A B C D E F G

Statement of Significance by Bonnie Parsons

The criteria that are checked in the above sections must be justified here.

This house would contribute to a potential historic district that extends north of Northampton’s primary corridor, Elm Street, encircling and encompassing the primary feature of that landscape, Round Hill. The potential historic district is significant for its 19th century development from a few gentlemen’s farms to a neighborhood dense with the homes of its most prominent residents and educational institutions that shaped the character of Northampton for several hundred years to the present. This house has particular significance as it was built for Benjamin Barrett Hinckley whose family had the nearby gentleman’s farm/estate known as “The Manse” and this house was part of the later development of the district so both eras are represented.

Architecturally the potential historic district is significant for the mix of late 19th century and early 20th century styles from the late Gothic Revival, Italianate, and Queen Anne styles to the early 20th century Colonial Revival and Tudor Revival style houses that were often architect-designed by the region’s most well-known designers. As a fine Colonial Revival style house, the Hinckley House contributes to the district’s significance. This potential historic district has integrity of workmanship, feeling, setting, design and materials.